

GOLD LINE

GIOVANNI

Lançamento 2021
 Coleção Let's Dance
 Design: Ále Alvarenga

Giovanni é a versão retrátil do grande sucesso que é o Sofá Giorgio. Seus gomos e formas robustas se repetem nesta versão, aumentando ainda mais a praticidade e beleza de um produto de linhas contemporâneas e acima de qualquer modismo.

Materiais

- Estrutura em madeira maciça de Eucalipto advindo de florestamento.
- Mecanismo retrátil de assento com abertura total de 50 cm.
- Braços em madeira maciça de Eucalipto e MDF
- Percintas Elásticas
- Assento em Espuma D-30 Soft e manta acrílica.
- Almofadas de encosto em fibra acrílica siliconada
- Revestimento em tecidos ou couros diversos.
- Pés em aço carbono laqueado.

01 Ass s/ braços

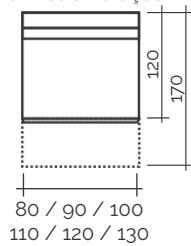

02 Ass s/ braços

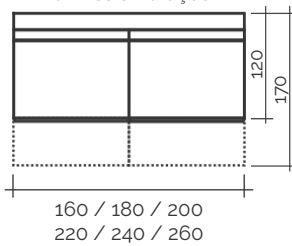

03 Ass s/ braços

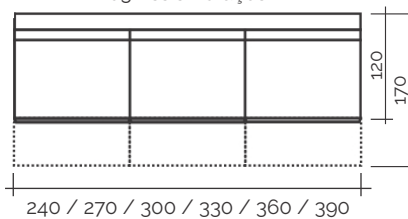

01 Ass c/ 01 braço

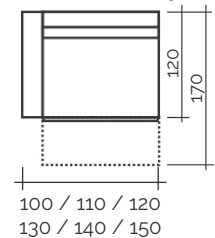

02 Ass c/ 01 braço

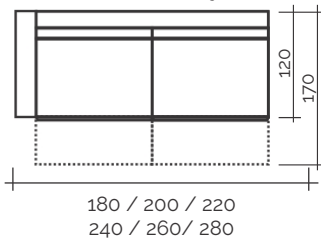

03 Ass c/ 01 braço

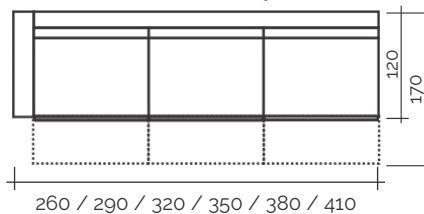

01 Ass c/ 02 braços

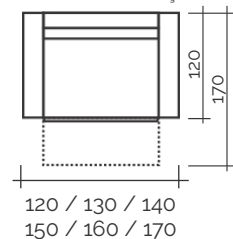

02 Ass c/ 02 braços

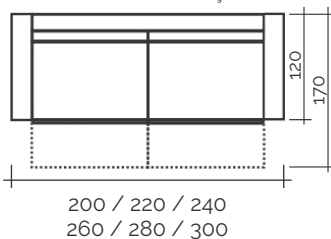

03 Ass c/ 02 braços

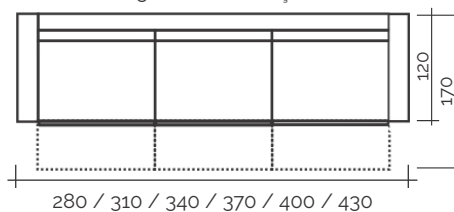

Lateral

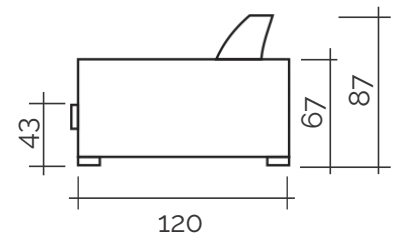

Chaise

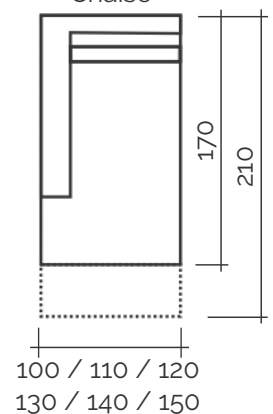

Pufe

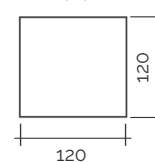

Canto

